

# BUSTER+PUNCH

LONDON

[ product.

## ESCUTCHEON PLATE / EURO

[ profile. **EURO.** ]

[ cc-distance. **27MM AND 35MM.** ]

[ diameter. **51MM.** ]

[ range. **DOOR HARDWARE.** ]

A euro cylinder plate made from solid spun metal. Works great on all internal doors and can be teamed up with our matching door handles and door knobs. Available in six metal finishes: steel, brass, smoked bronze, gun metal, welders black and black.

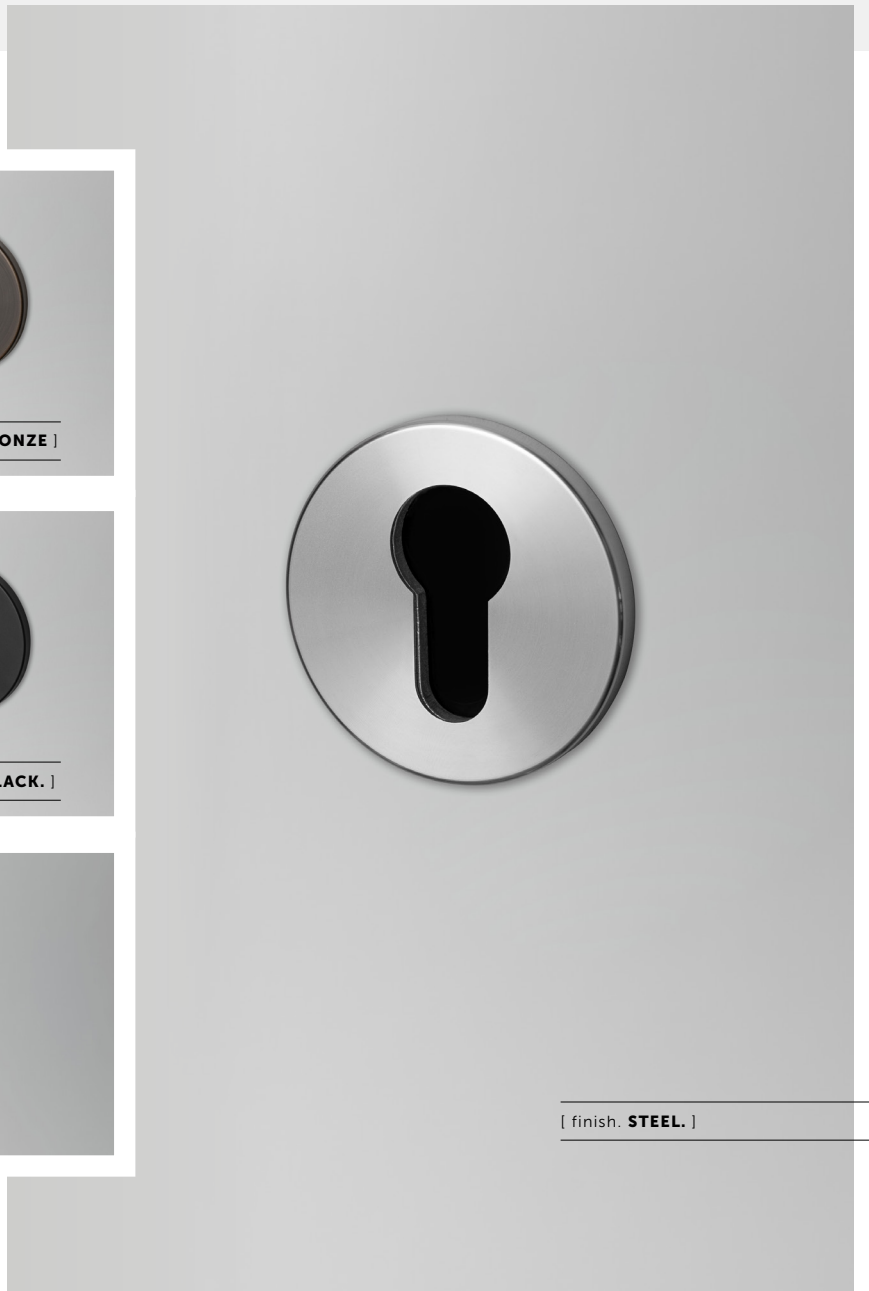
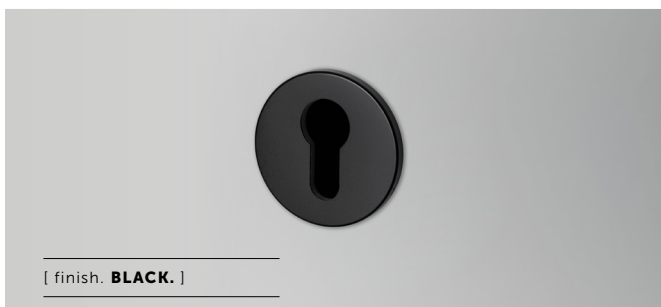
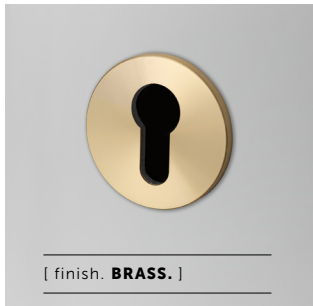

---

[ type. **ESCUTCHEON PLATE / EURO / 27MM.** ]

---

[ info. **MEASUREMENTS.** ]

---

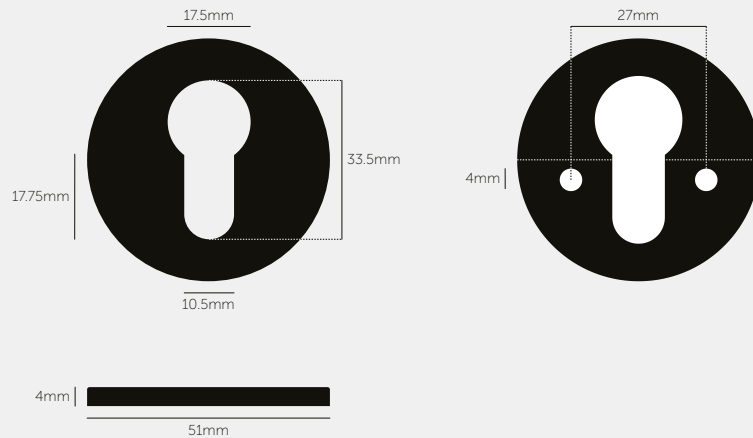

---

[ info. **SPECIFICATIONS.** ]

---

A pair of solid metal traditional profile escutcheon plates, 27mm\* centre distance. Suitable for interior doors only.

Fixing method: Bolt-through

Door thickness: 35-54 mm thick

Rose: 51 mm diameter rose, push fit

Projection: 4 mm





---

[ info. **FINISH & SKU NUMBERS.** ]

---

[ finish. ]

[ SWE. ]

 Steel	SW-CYL-27-ST-A
 Brass	SW-CYL-27-BR-A
 Smoked Bronze	SW-CYL-27-SM-A
 Gun Metal	SES-351879
 Welders Black	SES-591878
 Black	SW-CYL-27-BL-A

---

[ info. **CARE INSTRUCTIONS.** ]

---

Wipe with damp cloth with no loose hairs, avoid using any chemicals. All finishes are prone to aging.

---

[ info. **INCLUDED.** ]

---

**1 x pair of Euro Cylinder Plates**

Screw fittings

---

[ please. **NOTE.** ]

---

\*This number indicates the cc millimeter measurement for the screw holes that are used to fit the round plate to the door. 27 mm is standard for Sweden and most of Scandinavia.

DISCLAIMER: Always consult a trade professional when installing these escutcheon plates. Buster + Punch is not responsible for the usage or feasibility of installation requirements. This product is not suitable for damp or wet environments.

---

[ type. **ESCUTCHEON PLATE / EURO / 35MM.** ]

---

[ info. **MEASUREMENTS.** ]

---

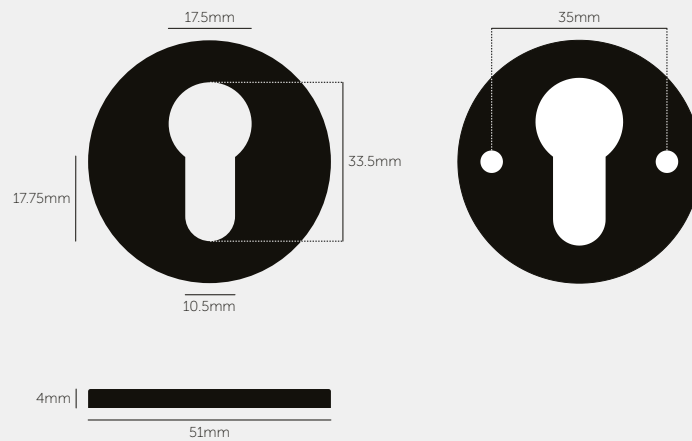

---

[ info. **SPECIFICATIONS.** ]

---

A pair of solid metal traditional profile escutcheon plates, 35mm\* centre distance. Suitable for interior doors only.

Fixing method: Bolt-through

Door thickness: 35-54 mm thick

Rose: 51 mm diameter rose, push fit

Projection: 4 mm

---

[ info. **FINISH & SKU NUMBERS.** ]

---

[ finish. ]

● Steel

● Brass

● Smoked Bronze

● Gun Metal

● Welders Black

● Black

[ UK. ]

UK-CYL-35-ST-A

UK-CYL-35-BR-A

UK-CYL-35-SM-A

RES-351875

RES-591874

UK-CYL-35-BL-A

---

[ info. **CARE INSTRUCTIONS.** ]

---

Wipe with damp cloth with no loose hairs, avoid using any chemicals. All finishes are prone to aging.

---

[ info. **INCLUDED.** ]

---

**1 x pair of Euro Cylinder Plates**

Screw fittings

---

[ please. **NOTE.** ]

---

\*This number indicates the cc millimeter measurement for the screw holes that are used to fit the round plate to the door. 35 mm is standard for UK and some parts of Europe.

DISCLAIMER: Always consult a trade professional when installing these escutcheon plates. Buster + Punch is not responsible for the usage or feasibility of installation requirements. This product is not suitable for damp or wet environments.